



MW12Z-001B

Digital Photo Frame User's Manual



For ongoing product improvement, this manual is subject to modification without prior notice.

Contents

User Notice

As this product has met electronic emission standards in registration for use at home, it can be safely used in all areas, including residential.



Chapter 1 Introduction

Product Introduction	3
Safety Precautions	4
Components	6
Player Overview	7

Chapter 2 Connection

Connection	12
Memory Card Extraction	14
PC Connecting	16

Chapter 3 Usage

Photo	18
Music	20
Back Music	23
Movie	24

Additional Functions	26
----------------------	----

Chapter 4 Editing & Settings

Editing	29
Settings	32

Chapter 5 Customer Management

Question&Answer	39
Troubleshooting	41
Product Specifications	42



Chapter 1

Introduction

Product introduction	3
Safety Precautions	4
Power Related	4
Product Related	5
Components	6
Basic components	6
Player overview	7
Electronic Frame	7
Remote Control	9

Digital Photo Frame

Product introduction

The Digital Photo Frame is a convenient image album that keeps your favorite images at your fingertips.

With its bright and vivid LCD screen, this Digital Photo Frame offers an alternative to photo printing, adding a new level of convenience to your life.

With its diverse file management functions, this Digital Photo Frame allows you to relive your cherished memories anytime.

Digital Photo Frame

Safety Precautions

Please read the following guidelines carefully to ensure user safety.

Power Related

⚠ WARNING: indicates information that, if neglected, could result in serious injury and/or death to the user.

⚠ CAUTION: indicates information that, if neglected, could result in injury to the user and/or material damage.

01. Use only the power supply included with your frame. Failure to do so may result in product malfunction.

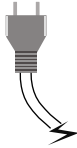

02. When connecting to your power source, make sure that your hands and feet are free of moisture. Failure to do so could result in electrical shock.

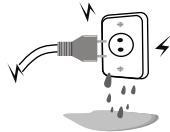

03. Make sure the power supply is firmly plugged in. A loose power cord could result in shock, or fire.

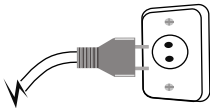

04. Do not let the power cord get tangled, and do not place heavy objects on the cord. Putting stress to the cord creates a fire hazard and the possibility of electric shock.

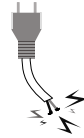

05. Do not overload power strips.

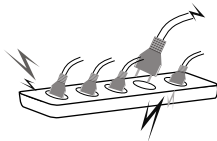

06. Disconnect the power supply during incremental weather conditions including lightning storms. Failure to do so may result in fire.



Digital Photo Frame

Safety Precautions

Please adhere to the following guidelines to ensure user safety, and avoid product malfunction.

Product Related

01. Dropping the product or subjecting it to a significant impact can cause critical damage.

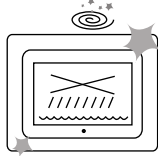

02. Spilling water or any other liquid on the product can cause critical damage.



03. Striking or scratching the LCD screen may cause permanent damage to the screen.

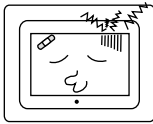

04. When cleaning the LCD screen, turn off the power and wipe it gently with a soft cloth.

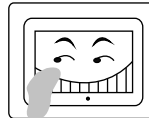

05. Do not subject the product to severe humidity and/or heat.

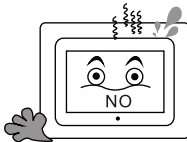

06. Make sure to power off the unit before disconnecting the power supply.

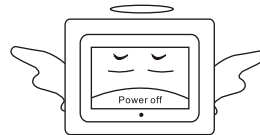

Digital Photo Frame

Components

For the improvement of product performance and/or quality, the basic components may be modified without prior notice.
The components may differ slightly in appearance with the provided images.

Basic Components

The components are provided upon product purchase.

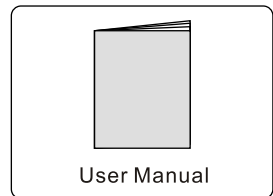
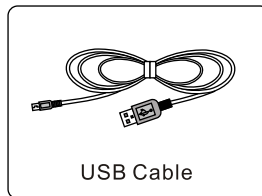
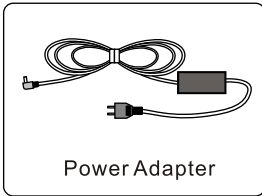
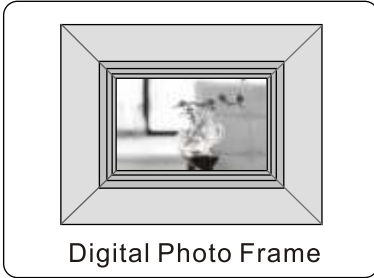

Digital Photo Frame

Player Overview

The components may differ slightly in appearance with the provided images.

Electronic Frame

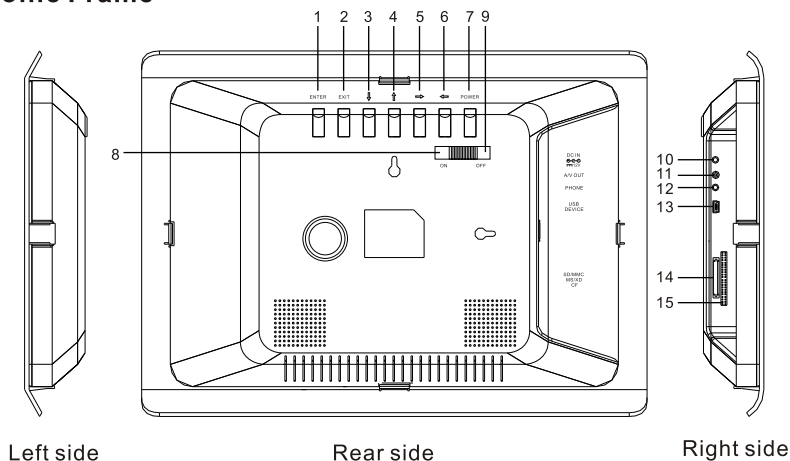

Rear side

1. ENTER : Enter /Confirm
2. EXIT: press EXIT to exit current menu.
- 3.DOWN: Move cursor down or flip left/right the picture.
4. UP: Move cursor up or flip up/down the picture.
- 5.RIGHT : Move cursor right or rotate picture clockwise .
- 6.LEFT ; Move cursor left or rotate picture counter - clockwise.
7. POWER: Switch the player between "on" and "off" modes.
8. ON : Power on .
9. OFF: Power off

Right side

10. DC IN: Input the DC power adaptor to the DPF player.
11. A/V OUT: Audio and Video output.
12. PHONE: Insert the earphone.
- 13.USB DEVICE: Connect the USB cable from the DPF player to PC.
14. SD/MMC/MS/XD: Insert SD/MMC/MS/XD.
15. CF CARD: Insert CF CARD.

Digital Photo Frame

Player Overview

The components may differ slightly in appearance with the provided images.

Rear side

- 12. Wall Mountable.
- 13. Stand: Using the stand provided you can stand the body with horizontal view.
- 14. Speaker: Built-in stereo speakers.

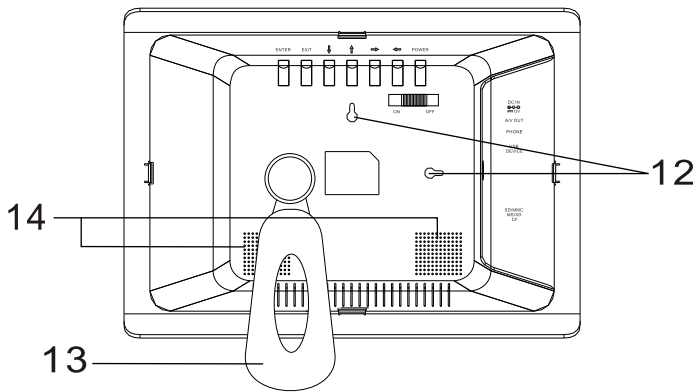

Rear side

Digital Photo Frame

Player Overview

The components may differ slightly in appearance with the provided images.

Remote Control



Power:

Press **POWER** to turn the player on and off.

Mute:

press **MUTE** to toggle sound on and off.

Photo:

Press **PHOTO** to start slide show of picture.

Music:

press **MUSIC** to play songs.

Movie:

Press **MOVIE** to play movies.

CALENDAR :

Display **CLOCK & CALENDAR** on screen.

SETUP:

Press to enter the **SETUP** menu.

Note: Remove Red Tab to activate battery.

Digital Photo Frame

Player Overview

ROTATE:

In the photo view state ,press this key to rotate , 90 degrees per time.

ZOOM:

In the photo view state ,press this key to zoom in .

BRIGHTNESS:

Enter the Display parameter setup function .

SLIDE SHOW :

In the photo view or music playing state ,press this key to display photos with background music.

AV OUT

Press to switch to Audio and Video output mode .

BACK MUSIC:

In the musical slide show mode , press this button to pause or play the background music.

NAVIGATION BUTTONS:

Press the arrow keys to move the cursor to the desired icon.

EXIT:

Press **EXIT** to stop the current action and return to previous menu.

PLAY/PAUSE:

press to **PLAY** or **PAUSE** a file.

STOP:

press to **STOP** current play back and return to file list.

PREV:

Press **PREV** to skip to the previous title/chapter/track/picture.

NEXT:

Press **NEXT** to skip to the next title/chapter/track/picture.

VOL+/-:

Press the **VOLUME** button to adjust the player's volume.



Chapter 2

Connection

Power Connection	12
Connect to USB Port	13
Memory Card Insertion	14
Memory Card Extraction	15
PC Connecting	16

Digital Photo Frame

Connection

Power Connection

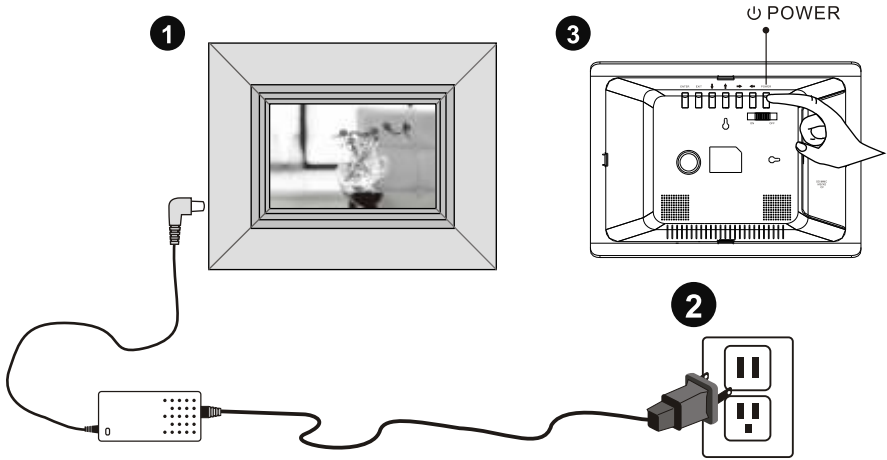

1. Connect the power adapter to the DC12V jack at the left side of the product.
2. Plug the power cable into a wall outlet.
3. The player will power on automatically.

Digital Photo Frame

Connection

Memory Card insertion

When inserting a memory card into the product, refer to the image to make sure that both the memory card and product are aligned correctly. (The side of the memory card on which the sticker is affixed should face to the front)

Aligning the memory card upside down or to the reverse side may cause damage that is the sole responsibility of the user. (Use of CF ,SD, Memory Stick, MMC cards, XD card enabled)

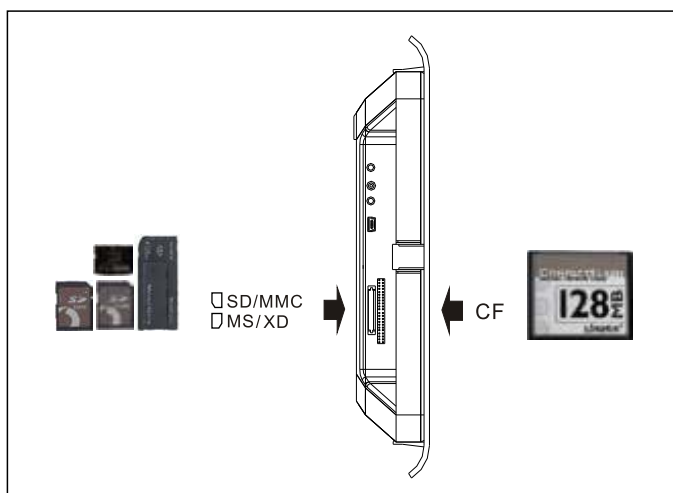

Digital Photo Frame

Connection

Removing Your Memory Card

Grip the card firmly between tow fingers , and pull the card straight out without bending it. Refer to the image below:

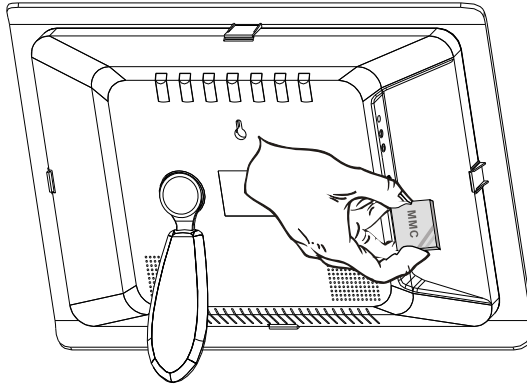

Note: the product will default to the images stored in internal memory when no extra memory card is present, or the product will default to the images stored in the inserted memory card.

Digital Photo Frame

PC Connecting

Connecting your DPF to your PC

Use the supplied USB cable to connect your DPF to your PC.

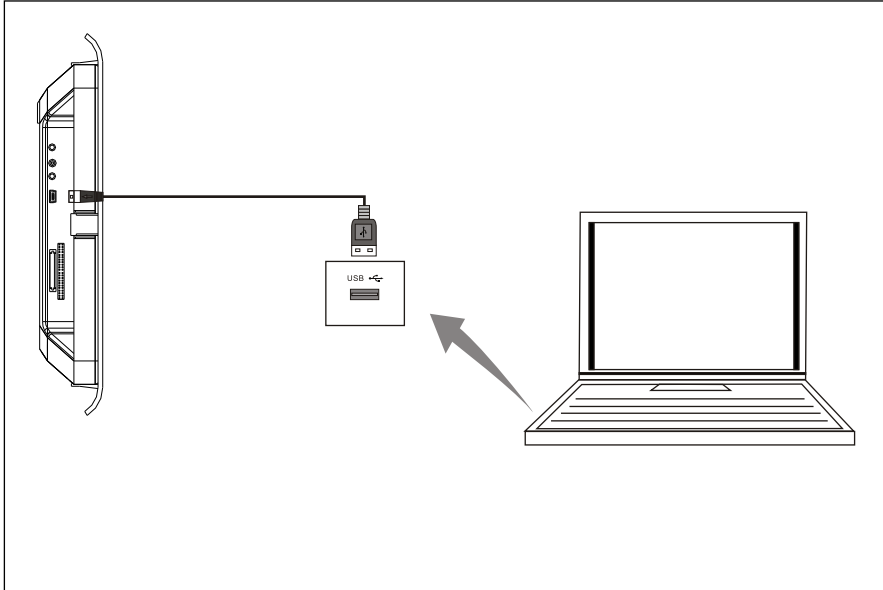

Digital Photo Frame

PC Connecting

1. After connecting with the PC, the PC's screen will display as the diagram below :

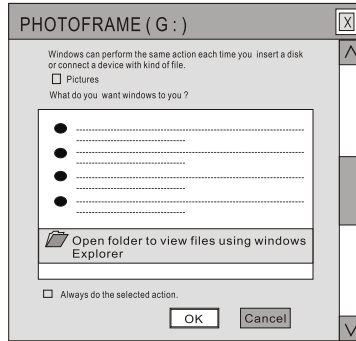

2. Press "OK", then the PC's screen will display the contents of memory. Then you can copy your required documents from your PC to your Multimedia DPF.
3. After copying the documents, close the window of the " Safety Remove Hardware" on your PC, then pull out the USB cable.
4. Then the Multimedia DPF will run normally.



Chapter 3

Usage

Photo	18
Music	20
Back Music	23
Movie	24
Additional Functions	26

Digital Photo Frame

Photo

Selecting a card

In the main menu, use the directional keys to select the desired card and press ENTER to enter into Select Mode screen.



Selecting a device

In the main menu, use the directional keys to select the desired device and press ENTER to enter into device list.



Viewing a photo in Full Screen

Use the directional keys to select the PHOTO item and press ENTER to enter the photo list, you can use the directional keys to select the photo you like, then press ENTER to browse it.



Digital Photo Frame

Photo

Rotating a Photo

After selecting the desired photo , use the **ROTATE** button to rotate(clockwise) the photo to the desired position. You can also rotate (clockwise) the player directly , the photo will rotate to the desired position automatically.



Digital Photo Frame

Music

Music

This is the music player function.

Selecting a card

In the main menu, Use the directional keys to select the desired card and press ENTER to enter into Select Mode screen.

Selecting a Music Item

Use the directional keys to select the MUSIC item and press ENTER to enter the music list .



Selecting a Music File

Use the directional keys to select the desired music file, press ENTER to play.

Digital Photo Frame

Music

Playing a Song

After selecting the desired music file ,
press the PLAY/PAUSE button.

Pausing Music

During playback, press the PLAY/PAUSE
 button.



Digital Photo Frame

Music

Adjusting the volume

During playback, use the Vol+ or Vol- buttons to adjust the volume.

Muting the Sound

During playback, Press the Mute button to mute the sound.



Digital Photo Frame

Back Music

Note : To utilize this feature you must have picture files (JPEG,BMP) and music files (MP3 or WMA) saved to the same file source(ie. Memory Card, USB removable storage device or Internal Memory).

In the main menu , use the arrow keys to select the desired card and press ENTER to enter Select Mode screen.

Use the arrow keys to select PHOTO/MUSIC , then press ENTER to enter the photo / music list.



Use the arrow keys to select a picture or song in the file list and press ENTER to play the file. Then press the PLAY /PAUSE button to play a musical slideshow starting with that file . Press BACK MUSIC to play or pause the background music.



Digital Photo Frame

Movie

A variety of movies including digital camera videos, music albums, etc. Can be played.

Selecting a card

In the main menu, use the directional keys to select the desired card and press ENTER to enter into Select Mode screen.



Selecting a Video File

Use the directional keys to select the VIDEO item and press ENTER to enter the movie list, you can use the directional keys to select the movie you like, then press ENTER to play it.



Selecting and Playing a movie (PLAY/PAUSE)

After selecting the desired movie, press either **ENTER** button or the **PLAY/PAUSE** button.



Digital Photo Frame

Movie

Adjusting the Volume

During playback ,use the VOL(+) or VOL (-) buttons to adjust the volume.

Muting the Sound

During playback, press the MUTE button to mute the sound.

NOTE: This frame supports the following video file types for playback:

- 1.MPEG-1, MPEG-4, AVI(upto D1, 2.8Mbps). Make sure the AVI formatted video files are available , or they may cause the player unable to work normally.
- 2.Videos recorded on most digital cameras.



Digital Photo Frame

Additional Functions

Zoom

During photo playback, Press ZOOM button to magnify the image as follows:

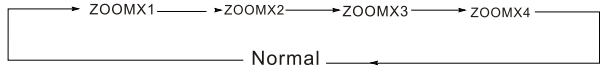

ZOOMX4



ZOOMX3



Normal



ZOOMX2



ZOOMX1

Digital Photo Frame

Additional Functions

SLIDE SHOW

Press **SLIDE SHOW** button.
Your frame will automatically create a slide show of the images on your internal memory.

BACK MUSIC

In the musical slide show mode , press **BACK MUSIC** button to play or pause the background music .

Note: Music must be Mp3 or WMA format .





Chapter 4

Editing & Settings

Editing

Copy file

Delete file

Settings

Photo Setting

Music Setting

Video Setting

System Setting

Reset Setting

Exit

29

29

31

32

32

34

34

34

37

37

Digital Photo Frame

Editing Files

In the main menu, use the directional keys to select the desired card and press ENTER to enter into Select Mode screen .Then select FILE, press ENETR to enter the file list.



A.Copy File

Use the directional keys to select the file you want to copy , then press SETUP button on the remote control to enter the setup menu, select Copy File item .



Then press ► or ENTER to enter the submenu, use ▲ or ▼ to select Copy One item or Copy All item , press ► or ENTER to select the card which you want to paste.



Digital Photo Frame

Edit Files

Use ▲ or ▼ to select Yes item and press ENTER to start transferring the file, as follows:



After the file is transferred successfully, your screen will display as follows:



Digital Photo Frame

Setting

Setting

Select SETUP button on the remote control to enter the setup menu.



1. Photo Setting

Image size

Select Photo item in the setup menu, press ► or ENTER , select Image Size, press ▲ or ▼ to change your selection(Original/Optimal 90% / Optimal 80%/ Optimal 70%/ Optimal 60%), then press ENTER to confirm.



Slide Show Shuffle

Select Photo item in the setup menu, press ► or ENTER , select Slide Show Shuffle and press ► or ENTER , press ▲ or ▼ to change your selection(Off / On), then press ENTER. to confirm.



Digital Photo Frame

Setting

Slide Show Effect

Select Photo item in the setup menu, press ► or ENTER ,select Slide Show Effect and press ► or ENTER, press ▲ or ▼ to change your selection(Off / Fade/Shutter/Cross Comb/Mask/Brick/Dissolve/Bar /Random). Then press ENTER to confirm.



Slide Show Speed

Select Photo item in the setup menu, press ► or ENTER , select Slide Show Speed and press ► or ENTER, press ▲ or ▼ to change your selection(Fast / Normal/ Slow). Then press ENTER. to confirm .



Slide Music

Select Photo item in the setup menu, press ► or ENTER , select Slide Music and press ► or ENTER, press ▲ or ▼ to change your selection (Off / On). Then press ENTER to confirm.



Digital Photo Frame

Setting

2. Music Setting

Music Repeat

Select Music item in the setup menu, press ► or ENTER to select Music Repeat, press ► or ENTER , then press ▲ or ▼ to change your selection(One / All / Off),then press ENTER. to confirm.



3. Video Setting

Video Repeat

Select Video item in the setup menu, and press ► or ENTER to select Video Repeat, press ► or ENTER , then press ▲ or ▼ to change your selection(One / All / Off),press ENTER to confirm.



4. System Setting

Select System item in the setup menu, press ► or ENTER ,select Clock , then press ► or ENTER.



Digital Photo Frame

Setting

Set Clock

Select Set Clock in the Clock menu, and press ENTER and use the directional keys to set time and date. Then press ► or ◀ to select Save, press ENTER. to confirm.



Clock Mode

Select Clock Mode in the Clock menu, and press ► or ENTER . Then press ▲ or ▼ to change your selection(Off or DD/MM/YYYY or HH: MM DD/MM), press ENTER to confirm.



Auto Slide Show

Select Auto Slide Show in the Clock menu, press ENTER and use the directional keys to set the slide show time . Then press ► or ◀ to select the box and press ENTER to confirm Then select Save and press ENTER to confirm .



Digital Photo Frame

Setting

Auto Power On

Select Auto Power On in the Clock menu, press ENTER and use the directional keys to set the auto power on time . Then press ► or ◀ to select the box and press ENTER to confirm Then select Save and press ENTER to confirm .



Auto Power Off

Select Auto Power Off in the Clock menu, press ENTER to change set and use the directional keys to set the auto power off time . Then press ► or ◀ to select the box and press ENTER to confirm Then select Save and press ENTER to confirm .



Digital Photo Frame

Setting

Calendar

Select Calendar in the Clock menu, and press ► or ENTER, then press ▲ or ▼ to change your selection(Off / Show Calendar), press ENTER to confirm.



5. Reset Settings

Select Reset Settings item in the setup menu, and press ► or ENTER, use ▲ or ▼ to select Yes item and press ENTER.



6. Exit

Select Exit item in the setup menu, and press ENTER to return to the main menu.





Chapter 5

Customer Management

Question & Answer	39
Troubleshooting	41
Product Specifications	42

Digital Photo Frame

Question & Answer

Q&A

This chapter will attempt to troubleshoot common problems that one may experience with the Multimedia DPF, If this guide does not solve your problem. Do not dismantle the machine yourself.

Question	Answer
What photo and video formats are supported by the Multimedia Digital Photo Frame?	Photo: JPEG ,BMP. Video: AVI, MPEG I, IV Audio: Mp3, WMA
What memory cards are compatible with the digital frame?	Secure Digital Card (SD)/MultiMedia Card (MMC) , Memory Stick,CF(Type I), XD,Memory stick Pro.
How do I store music files?	Use a personal computer and a popular audio editing software such as Music Match to convert your music to the format that the player can support. Transfer the music file to the memory card by using a Memory Card Reader.
Dose Multimedia Digital Photo Frame have built-in memory?	Yes. The player has an internal memory to store media file. Its memory volume is 512M. Do not rename the memory's name.
Can I insert multiple memory cards?	Yes,you can insert one CF card with one of SD, MMC, MS ,MS Pro,XD at the same time.
What is the best picture resolution displayed on the screen?	The player's best resolution is 800(RGB)X480.
Can I rotate a picture on the screen?	Yes. Use the ROTATE buttons on the remote control to rotate a picture. Note: The rotated picture will return to its original orientation after you power off the digital frame.
Why Digital picture Frame does not advance to next picture?	1. There is only one picture in the frame. 2. You are viewing high -resolution pictures on the card, High-resolution pictures can take some time to display. 3. You are in still display mode. 4. The next picture has been broken.

Digital Photo Frame

Question & Answer

Why can't my PC find the internal memory?	Turn on the multimedia digital photo frame and wait for the function menu to appear, then connect the USB cable from the unit to PC, If the found new device prompt does not appear on your computer screen, look in "my computer" for a USB mass storage device.
Why the unit can't play pictures?	1. Ensure the pictures are stored in the card or USB. 2. The unit only recognizes pictures stored in JPEG, BMP format. 3. If can not play the pictures, please format your card / internal memory.
Why won't my multimedia digital photo frame play my downloaded music?	The player can play music in some formats.
Why doesn't the photo cover the entire screen?	The resolution required for a picture to cover the entire screen must be greater than 800X480 pixels.
Can the DPF player connect with all computers?	No, the USB port of the PC connected with the player must be USB 2.0, and the PC must be windows system (eg. windows 2000, windowsXP, etc).

Digital Photo Frame

Troubleshooting

Consult the troubleshooting guide below if you are experiencing any problems with the unit. A minor adjustment may eliminate the problem.

No Power

Press and hold the power button
Ensure the power cord is not damaged
Ensure the power plug is connected firmly to a working outlet.

Cannot read WMA music:

This unit only supports WMA with bit rate: 32Kbps - 192kbps

Cannot read card.

1. Please copy the content of your card to your PC, then format your card. Repaste the photos/music/movies onto your card, and then reinsert the card into your DPF.
2. Ensure the card is not damaged.
3. Ensure the card is correctly and firmly connected to the DPF.
4. Ensure the card has content (photos, music, or movies). If there is no content on the card, the screen will display "Files can't be found"

Remote control not working

1. Ensure the batteries are inserted
2. Ensure the batteries' protective plastic tab is pulled out.

Digital Photo Frame

Product Specifications

Specifications can be changed without prior notice in the interest of improving product performance.

Product Specifications

Item		Details
LCD Display	Size	11.1 Inch (Diagonal)
	Resolution	800(Horizontal)*480(Vertical)
	Brightness	350cd /m²
	Contrast Ratio	500:1
Memory	Internal Memory	512MB
	Compatible Memory Cards	CF / SD / MMC / Memory Stick / XD
Remote Control		25Keys
Support Media Formats	Images	JPEG, BMP
	Video	AVI , MPEG I, IV
	Audio	Mp3, WMA
Internal Speaker	Stereo	1W*2, 400HZ~20KHZ
Power	Adapter	Input: 100~240V AC, Output: 5V, 2A DC
	Electricity Consumption	15 W (Operating)
Size	Width*Height*Depth	320(w)*230(h)*30(d)[mm]
USB Connection	USB Device	

Digital Photo Frame

FCC and Safety Information

• FCC Part 15.19

This device complies with Part 15 of the FCC Rules .Operation is subject to the following two conditions: (1) this device may not cause harmful interference , and (2) this device must accept any interference received ,including interference that may cause undesired operation .

• FCC part 15.21

Warning: Changes or modifications to this unit not expressly approved by the party responsible for compliance could void the user’ s authority to operate the equipment.

• FCC part 15.105

Note : This equipment has been tested and found to comply with the limits for a Class B digital device ,pursuant to Part 15 of the FCC Rules, These limits are designed to provide reasonable protection against harmful interference in a residential installation . This equipment generates, uses, and can radiate radio frequency energy and ,if not installed and used in accordance with the instructions, may cause harmful interference will not occur in a particular installation .If this equipment does cause harmful interference to radio or television reception ,which can be determined by turning the equipment off and on ,the user is encouraged to correct the interference by one or more of the following measures:

- Reorient or relocate the receiving antenna.
- Increase the separation between the equipment and receiver.
- Connect the equipment into an outlet on circuit different form that to which the receive is connected.
- Consult the dealer or an experienced radio TV technician for help.

LIMITED WARRANTY

The limited warranty set forth below is given by Sungale Group Inc. ("SGI") with respect to Sungale brand DPF players and other consumer electronics products purchased and used in the United States of America. SGI warrants this product against defects in material or workmanship as follows:

LABOR: For a period of ninety (90) days from the date of purchase, if this Product is defective, SGI will repair or replace the Product, at its option, at no charge. After this ninety (90) days period up to one year, a labor charge of US\$30.00 will be charged for each service.

PARTS: For a period of one year from the date of purchase, SGI will supply, at no charge, new or rebuilt replacement parts in exchange for defective parts. After this one year period, SGI will charge the new or replacement parts.

This warranty does not cover: (1) customer instruction, installation or set up; (2) cosmetic damage or damage due to accident, misuse, abuse, or negligence; (3) commercial use of the Product; (4) modification of any part of the Product; (5) damage due to improper operation, improper maintenance, or connection to an improper voltage supply; (6) damage due to an attempted repair of the Product by anyone other than a facility authorized by SGI to service the Product; (7) consumables (such as fuses and batteries). This warranty is valid only in the United States.

The product must be accompanied by a copy of the original retail purchase receipt. If no proof of purchase is attached, the warranty will not be honored and repair cost will be charged.

This warranty is valid with attach written documentation detailing the complaint to the outside or inside of the carton.

This warranty is invalid if the factory applied serial number has been altered or removed from the Product.

SGI reserves the right to modify any design of this product without prior notice.

To obtain warranty service, you must deliver the product freight prepaid, in either its original packaging or packaging affording an equal degree of protection, plus proof of purchase, to:

Service Center
13358 Monte Vista Avenue,
Chino, CA 91710
Tel: **800-473-5156**

REPAIR OR REPLACEMENT AS PROVIDED UNDER THIS WARRANTY IS THE EXCLUSIVE REMEDY OF THE CONSUMER. SGI SHALL NOT BE LIABLE FOR ANY INCIDENTAL OR CONSEQUENTIAL DAMAGES FOR BREACH OF ANY EXPRESS OR IMPLIED WARRANTY ON THIS PRODUCT. EXCEPT TO THE EXTENT PROHIBITED BY APPLICABLE LAW, ANY IMPLIED WARRANTY OF MERCHANTABILITY OR FITNESS FOR A PARTICULAR PURPOSE ON THIS PRODUCT IS LIMITED IN DURATION TO THE DURATION OF THIS WARRANTY.

Some states do not allow the exclusion or limitation of incidental or consequential damages, or allow limitations on how long an implied warranty lasts, so the above limitations or exclusions may not apply to you. This warranty gives you specific legal rights, and you may have other rights which vary from state to state.

Digital Photo Frame

Sungale