

## Instruction

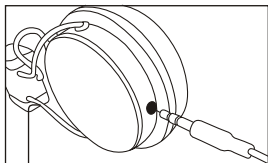
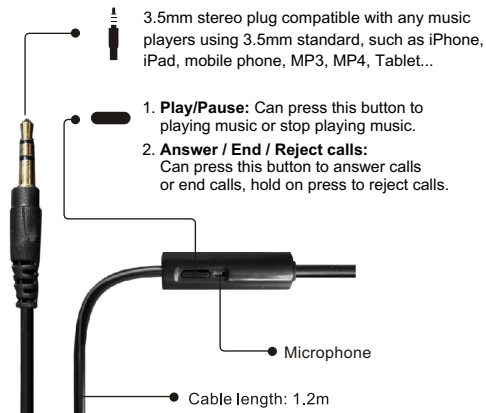

Foldable, Adjustable

## Specifications

- Speaker diameter:  $\Phi 40\text{mm}$
- Frequency response: 20Hz - 20kHz
- Impedance:  $32\Omega \pm 15\%$
- Speaker sensitivity:  $85\text{dB} \pm 3\text{dB}$
- Rated power: 25mw
- Max input power: 50mw
- Cable length: 1.2m cord with microphone
- Plug type:  $\Phi 3.5\text{mm}$

## Notice

1. Do not hit or beat the product.
2. Do not throw the product into fire.
3. Non-professionals do no disassemble the headphones.
4. Please use the moderate volume to avoid harming listening.
5. Please do no use the headphones in exposed liquid, moisture environment.
6. For long-time storage, keep the headphones in a well-ventilated place without high temperature sand humidity.
7. Cleaning the headphones  
Use a cleaning cloth to wipe away dirt on the headphones.  
When cleaning the housing with a cloth, do not apply strong force.  
Dust the surface first, and then wipe the surface gently using a dry cloth.